

**MATERIALE:**  
 Beton de egalizare C12/15 CEM III/A-S 32.5 N ; sort 0-31; A/C : 0.75 ;  
 Beton armat de monolitizare C30/37 CEM III/A-S 42.5 N ; sort 0-16; A/C : 0.55;  
 Mortar M100-T  
 Armatura Bst500, Bst500  
 Clasa de expunere: XC4 , XD3 , XF4

**MATERIALS:**  
 Equalization concrete C12/15 CEM III/A-S 32.5 N ; sort 0-31; A/C : 0.75 ;  
 Reinforced concrete C30/37 CEM III/A-S 42.5 N ; sort 0-16; A/C : 0.55;  
 Mortar M100-T  
 Reinforcement Bst500, Bst500  
 Exposure class: XC4 , XD3 , XF4

**NOTA:**  
 In situatia demontarii prefabricatelor din spre linie pentru executarea lucrarilor la linie  
 cu masini grele de cale sa va aplica urmatoarea tehnologie:  
 Se decoperteaza asfaltul in zona monolitizarii dintre prefabricate (DP1)  
 Se demoleaza betonul de monolitizare  
 Se taie armaturile in zona centrata a monolitizarii (la min. 1.50m de la marginea peronului)  
 Se demontaza prefabricatele si se depoziteaza in aceiasi sectiune pe exteriorul peronului  
 (prefabricatul demontat se depoziteaza pe cel care nu se demonteaaza)  
 Se executa lucrarile la cale  
 Se refaca peronul prin montarea prefabricatelor prefabricatelor pe pozitia initiala  
 Pe masura ce se monteaza elementele prefabricate de peron se asigura continuitatea  
 armaturilor, laiate in faza 3, cu eclise din Bst500 Ø10mm l=250mm sudate  
 Se monolitizeaza cu beton C30/37 zona demolata si se refaca asfaltul decopertat.

**NOTE:**  
 The following technology will be applied in case when the prefabricated elements from  
 the line will be removed in order to execute the line works with heavy track machines:  
 The asphalt uncovering in the concrete cast in position area between prefabricated  
 elements (DP1)  
 Removing the cast-in-place concrete  
 Cutting the reinforcements in the central area of the concrete cast in position  
 (at min.1.50 m from the platform edge)  
 Removing the prefabricated elements and storing them in the same section on the platform  
 exterior side (the removed prefabricated unit is stored on the one which is not  
 removed)  
 Track works execution  
 Renewing the platform by mounting prefabricated elements on the initial position  
 While mounting the prefabricated elements on the platform it is ensured the continuity of  
 reinforcement that were cut at point 3, by help of Bst500 welded fishplates having Ø  
 10mm and l = 250 mm  
 The removed area is casted-in-place with concrete C 30/37 and the uncovered asphalt is  
 renewed.

**NOTA GENERALA VALABILA PENTRU INTREGUL PROIECT:**  
 Executantul este obligat sa verifice informatiile din planuri si din extrasele de materiale  
 inainte de comandarea oricaror materiale si sa comunice orice neconcordanta proiectantului.  
 In caz contrar proiectantului nu isi va asuma responsabilitatea pentru nici o eroare din planuri  
 sau din extrasele de materiale.

**UNIVERSAL REMARK VALID FOR THE ENTIRE PROJECT:**  
 The executants is bound to verify all the information from the plans and from the material  
 lists before ordering any materials and to communicate any disparity to the designer.  
 Other way the designer will not assume the responsibility about the errors in the plans  
 or in the material lists.

**CLASA DE IMPORTANTA A CONSTRUCTIEI**  
 CONFORM P1000/1-2006 ESTE III: CATEGORIA DE  
 IMPORTANTA CONFORM H.G. NR. 766/97 ESTE "C".  
**THE CONSTRUCTION IMPORTANCE CLASS,**  
 ACCORDING TO P1000/1-2006 IS III:  
 CATEGORY, ACCORDING TO H.G. 766/97 IS "C".

Extras de armatura / buc. stalp electrificare		Reinforcement extract / pcs. electrification pole		5255	
Marca/ Mark	Diametru/ Diameter (mm)	Nr. Buc./ No. of pieces	Lungime/ Length (m)	Ø 8	Ø 10
1	8	95	1.30	123.50	Ø 112
2	10	13	3.25	-	42.25
3	10	13	3.60	-	46.80
4	12	12	1.30	-	15.60
5	10	7	2.00	-	14.00
5'	10	7	3.30	-	23.10
6	10	13	1.45	-	18.85
7	8	13	0.75	9.75	-
8	8	28	0.30	8.40	-
9	10	9	3.62	-	32.58
9'	10	3	2.45	-	7.35
10	10	2	3.76	-	7.52
10'	10	2	2.52	-	5.04
11	10	18	1.51	-	27.18
11'	10	18	1.76	-	31.68
12	10	24	1.71	-	41.04
13	10	9	5.65	-	50.85
Lungime totala pe diametre / Total length on diameter (m)				141.65	145.00
Masa pe metru / Mass on meter (kg/m)				0.395	0.617
Masa pe diametre / Mass on diameter				55.95	89.47
Masa totala pe tip de otel / Total mass on steel type (kg)				160.00	

Extras de laminate [pe ml de peron]		Rolled steel extract [by ml platform]		Calitate / Quality	
Pozitie / Position	Element / Element	Lungime / Length (m)	Bucati / Pieces	Greutate / Weight (kg)	Total
P1	L60x60x5	1.00	1	4.57	4.57
P2	L45x30x4	1.00	1	2.25	2.25
P3	Pb 50x4-50	0.05	4	1.57	0.785
P4	M6-50	-	4	-	0.12
Total / Total (kg)				8.49	7.2540
Sudural / Weiding (3%)				0.2176	0.2176
Greutate totala / Total weight (kg)				8.7116	7.4716

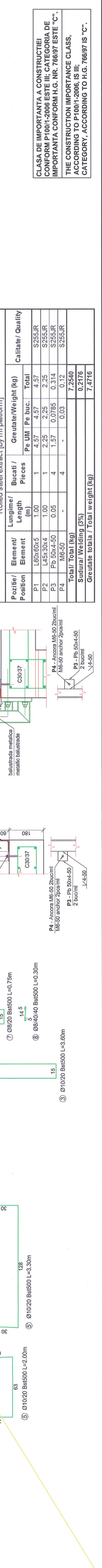
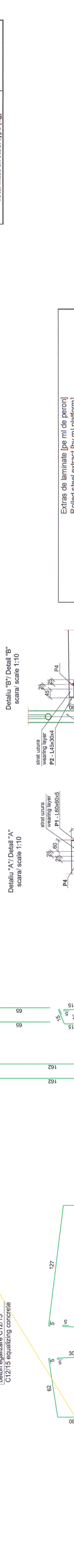
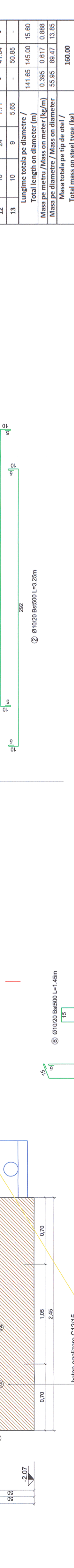
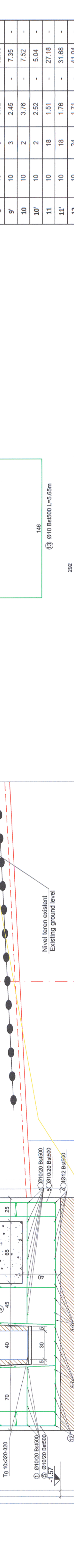
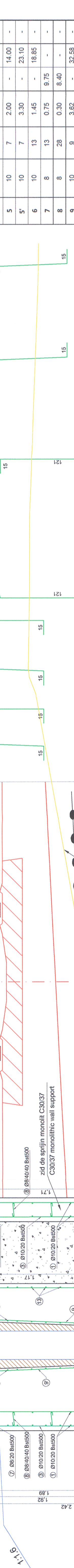

Accest plan anuleaza si inlocuieste planul nr. PT.03.03.23.3.RE.01.006 elaborat la data 01.2013.

This layout plan canceled and replaced layout plan no. PT.03.03.23.3.RE.01.006 prepared on 01.2013.

Referat / Expertiza Report / Expertise

Verificator / Expert Checker / Expert

Centra Requirement

Semnatura Signature

MINISTERUL TRANSPORTURILOR

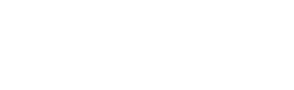

PROIECTANT / DESIGNER: PÖYRY

Șef de echipă / Team leader: C. Teodorescu

Expert Cheie / Key Expert: R. Wilian

Subcontractant / Subcontractor: VIOTOP

Approbat / Approved: A.M. Baicu

Verificat / Checked: D. Oprescu

01.2013

01.2013

01.2013

Project 9/ 35311.1

Faza / Phase: PTh+CS / TD+TS

Denumire desen / Drawing name: "Reabilitarea liniei c.f. Frontieră - Curtici - Simeria, parte componentă a coridorului IV Pan - European pentru circulația trenurilor cu viteză maximă de 160 km/h"

"Reabilitarea liniei c.f. Frontieră - Curtici - Simeria, componentă Part of the IV Pan - European Corridor for the Trains Circulation with maximum speed of 160 km/h"

Section 3: Gurasada - Simeria

P.O. Vețel, Poroane. Plan secțiune peron zonă stîlp electrificare

S.P. Vețel, Platforma. Current section platform plan electrification pole

Cod desen / Drawing Code: PT.03.03.23.3.RE.01.006

Scara / Scale: 1:10;1:20

Revizia / Revision: 1/05.2013

Nr. / No: 06/06